

Figura 5.1

Tabelul 5.1

Tipul masinii antrenate	k_s
Generatoare electrice	1 - 2
Ventilatoare	1,25 - 2
Pompe centrifuge si cu piston; compresoare cu piston	1,75 - 3,5
Masini-unelte	1,25 - 2,5
Masini-unelte pentru lemn; transportoare cu banda si cu lant	1,5 - 2
Transportoare cu role	4
Masini de ridicat; elevatoare	3 - 5



Figura 5.2.a



Figura 5.2.b

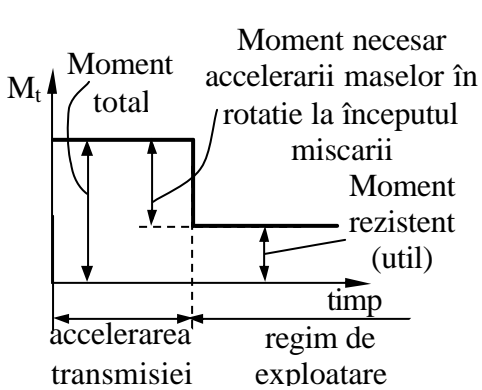

Figura 5.2.c

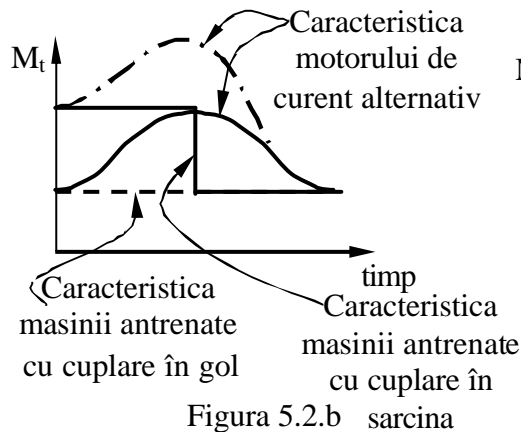

Denumirea	Figura	Caracteristici si elemente constructive
Cuplaj cu manson monobloc	5.4 a	Momentul de torsiune se transmite prin intermediul stifturilor. Turatii acceptate: 200 ... 250 rot/min. Diametrele arborilor cuplati sunt cuprinse între 5 si 500 mm.
	5.4 b	Momentul de torsiune se transmite prin intermediul penelor sau canelurilor. Turatii acceptate: 200 ... 250 rot/min. Diametrele arborilor cuplati sunt între 5 si 500 mm.
	5.4 c	Momentul de torsiune se transmite prin frictiune, cu ajutorul strângerii exercitate de asamblarile pe con si prin pene paralele. Transmit momente de torsiune de 500 ... 1700 Nm. Diametrele arborilor cuplati sunt cuprinse între 10 si 70 mm.
	5.4 d	Momentul de torsiune se transmite prin frictiune, cu ajutorul strângerii exercitate de asamblarile pe con. Transmit momente de torsiune de 500 ... 1700 Nm. Diametrele arborilor cuplati sunt cuprinse între 10 si 70 mm.
	5.4 e	Momentul de torsiune se transmite prin frictiune, cu ajutorul strângerii exercitate de asamblarea pe con cu ulei sub presiune. Diametrele arborilor cuplati sunt cuprinse între 25 si 1000 mm.
Cuplaj cu manson din doua bucati	5.5	Asamblarea semimansoanelor se face cu suruburi, în vederea transmiterii momentului de torsiune prin frictiune. Pentru siguranta se utilizeaza si pene paralele. Pentru arbori verticali, penele paralele sunt prevazute cu ciocuri la ambele capete. Diametrele arborilor cuplati sunt cuprinse între 18 si 200 mm.

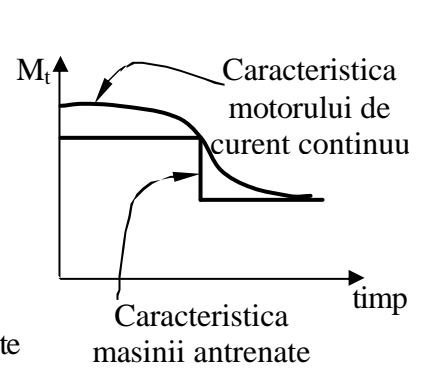
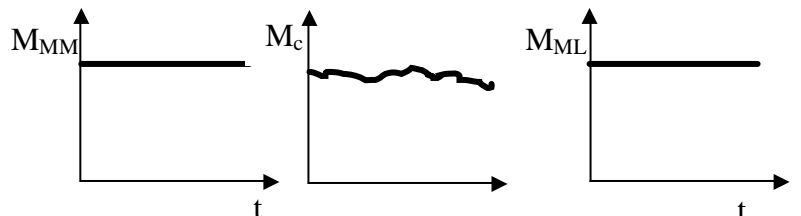
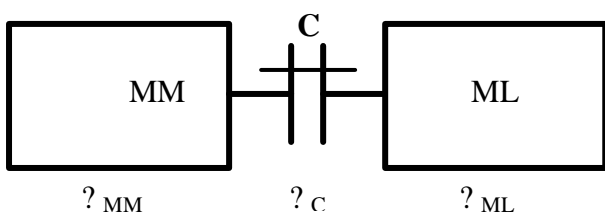

Figura 5.5



Figura 5.4

e)

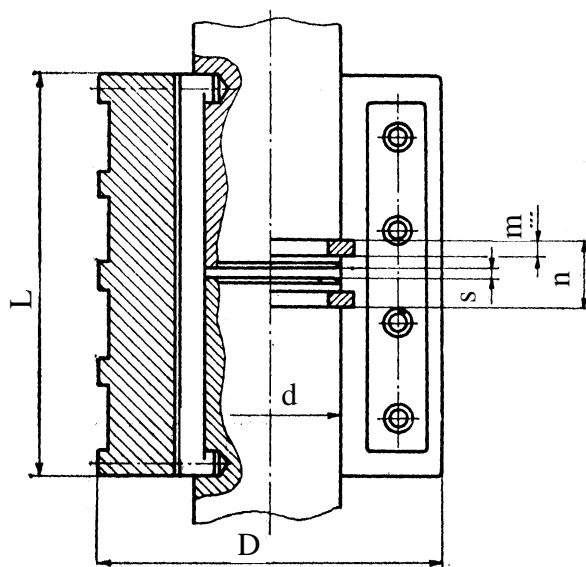
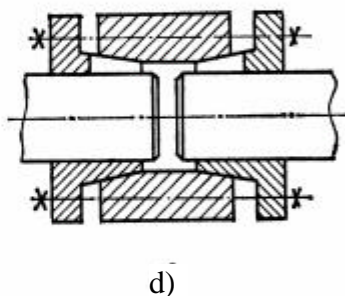
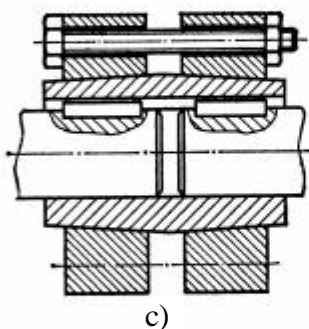
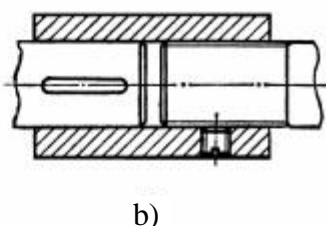
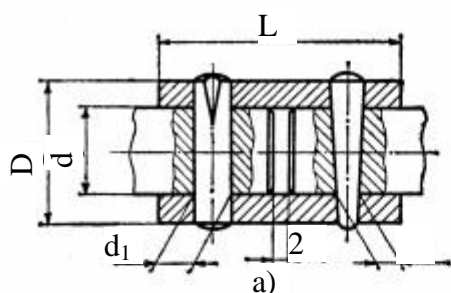

Figura 5.6

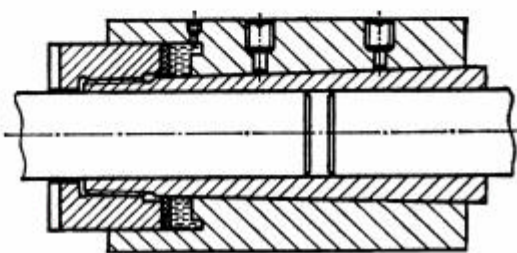

a)

b)

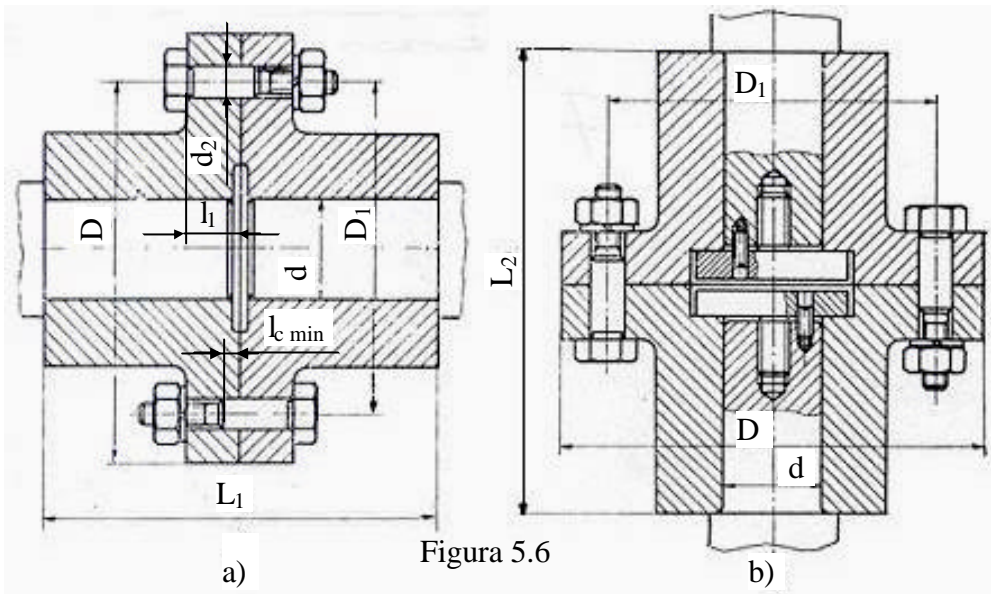
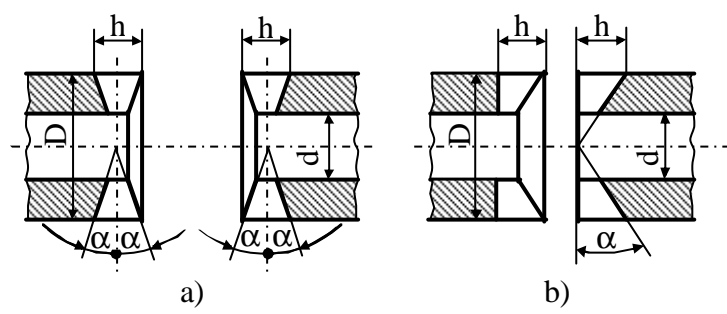
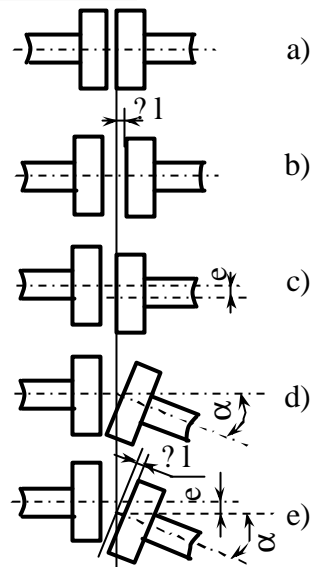
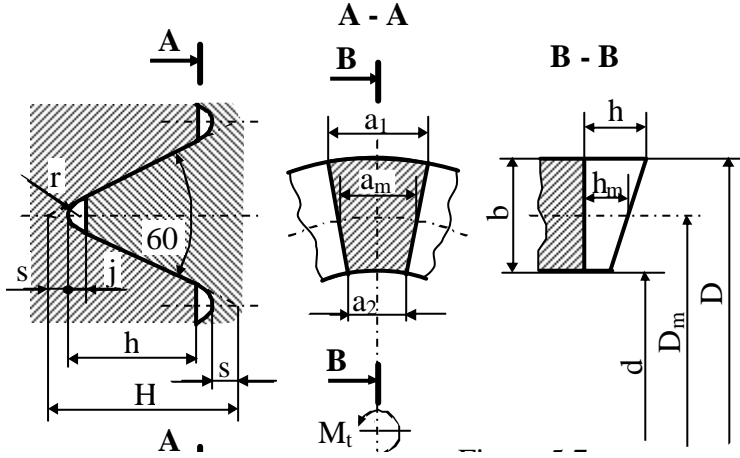

a)

b)

c)

d)

e)

Figura 5.8

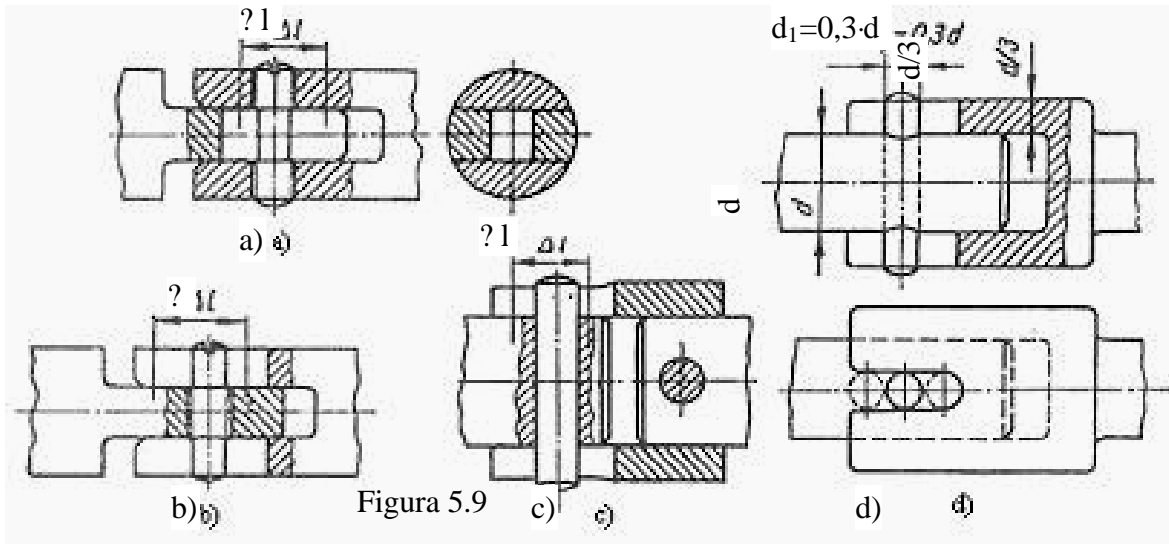

a) a)

b) b)

c) c)

d) d)

Figura 5.9



Figura 5.10



Figura 5.11

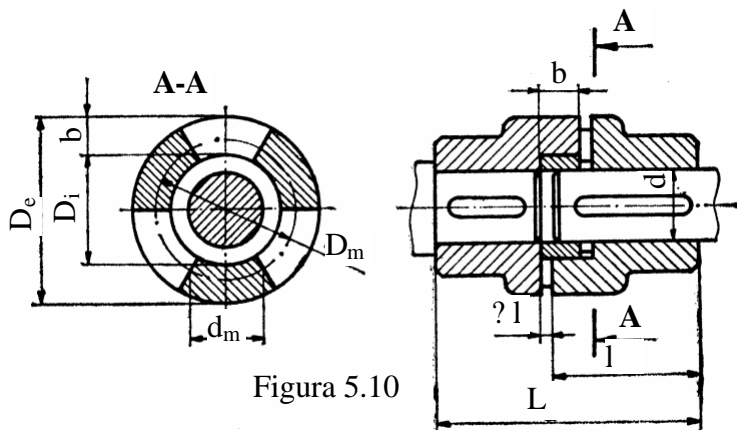

Figura 5.12

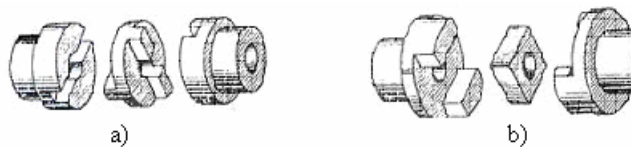

Figura 5.11.c)

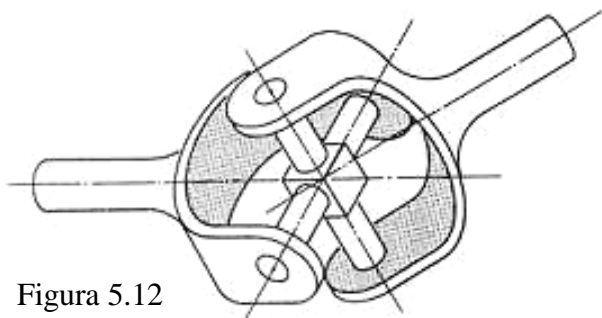

Figura 5.13

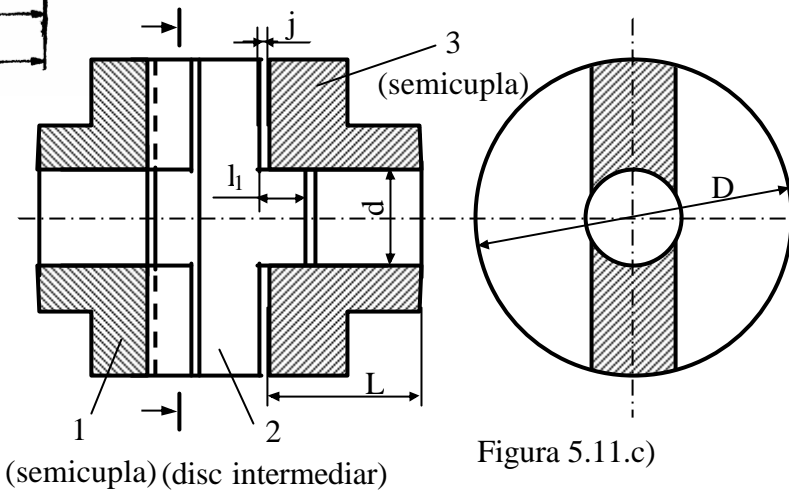

Figura 5.14

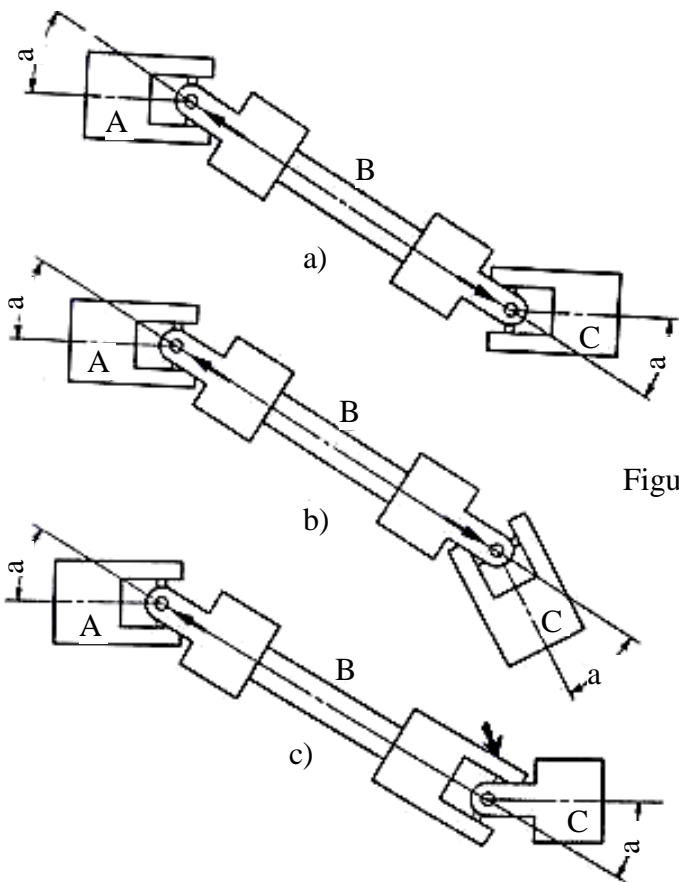

Figura 5.15

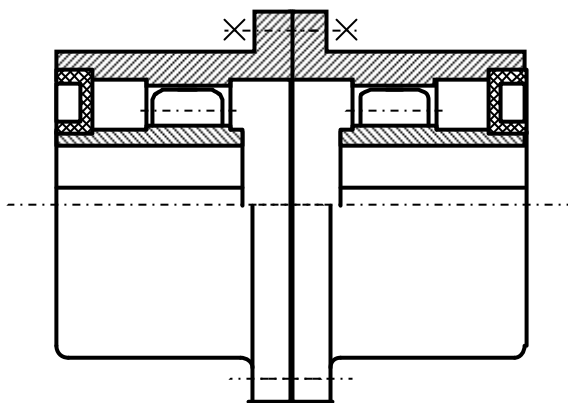

Figura 5.20

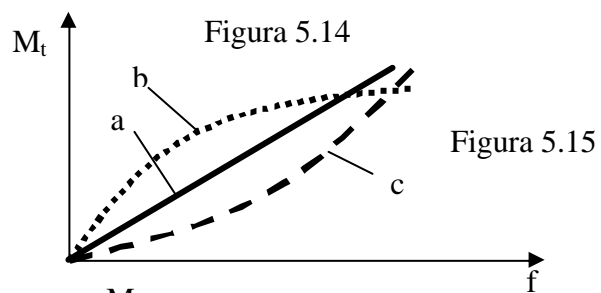

Figura 5.18

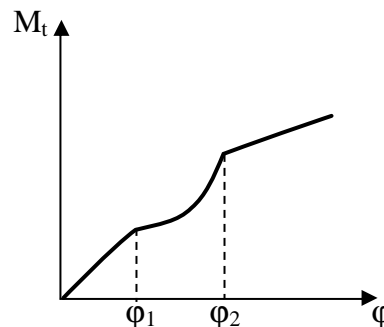

Figura 5.19

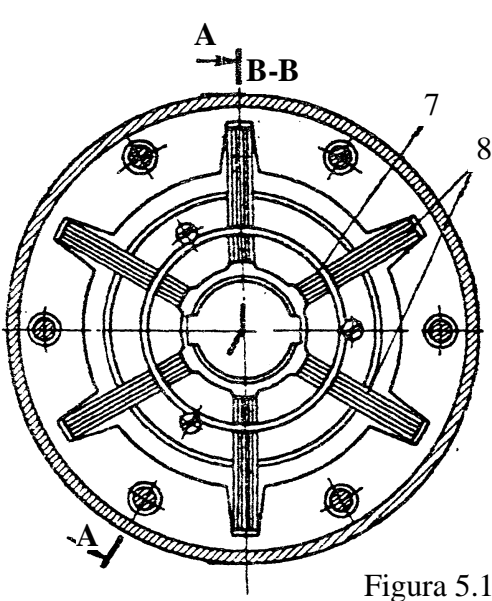

Figura 5.21

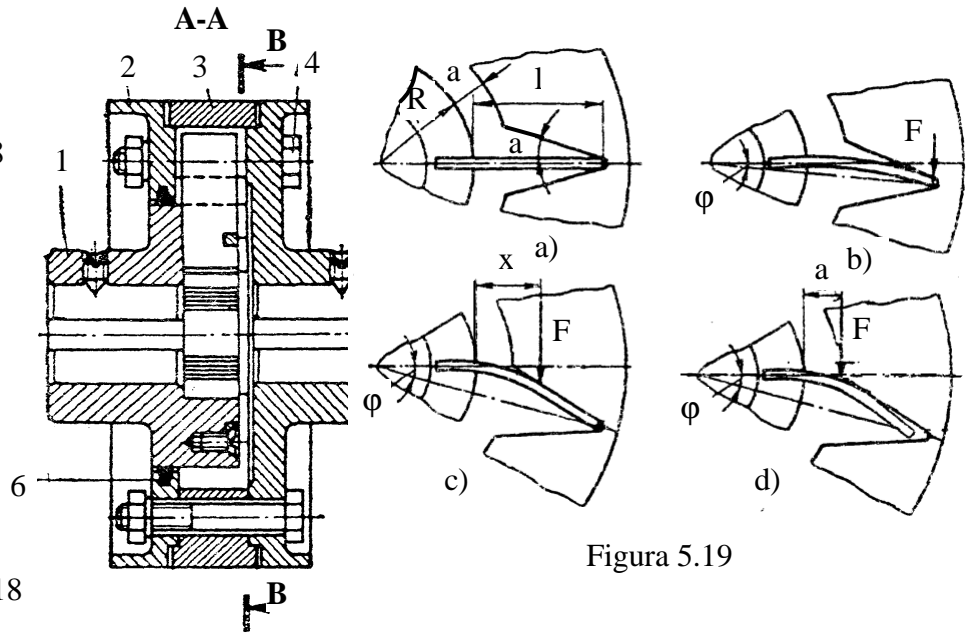

Figura 5.22

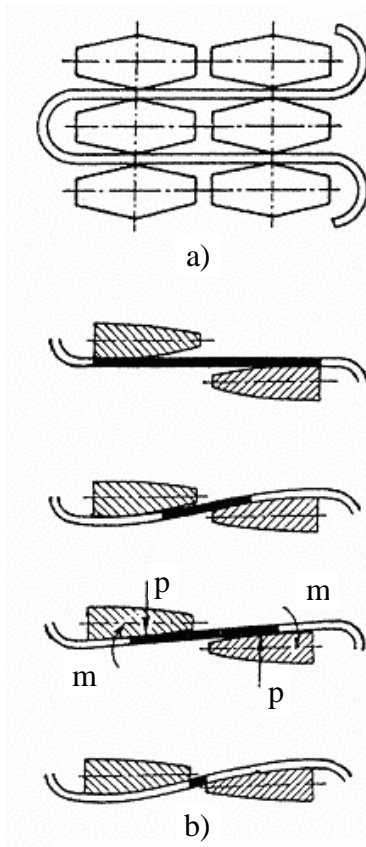

Figura 5.23

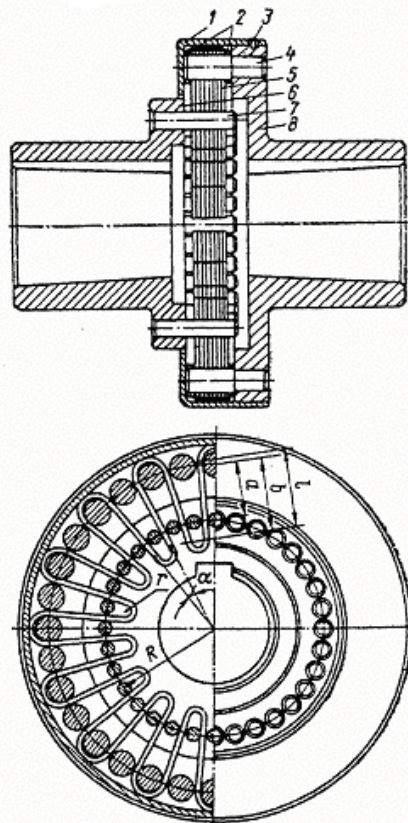

Figura 5.24

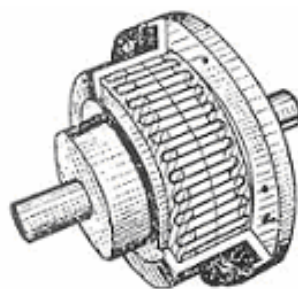

Figura 5.25

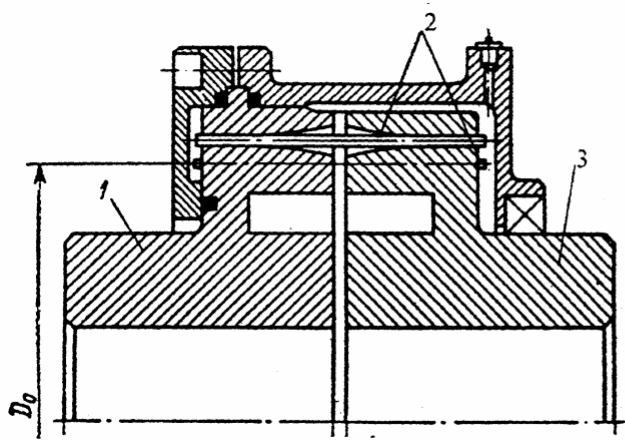

Figura 5.26

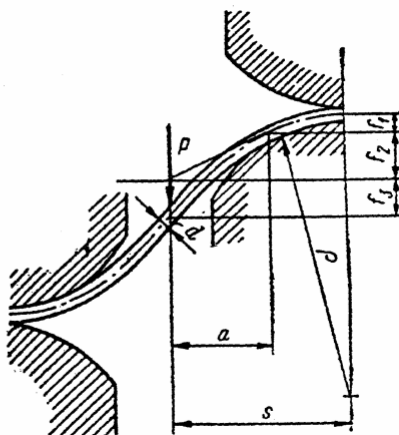

Figura 5.27

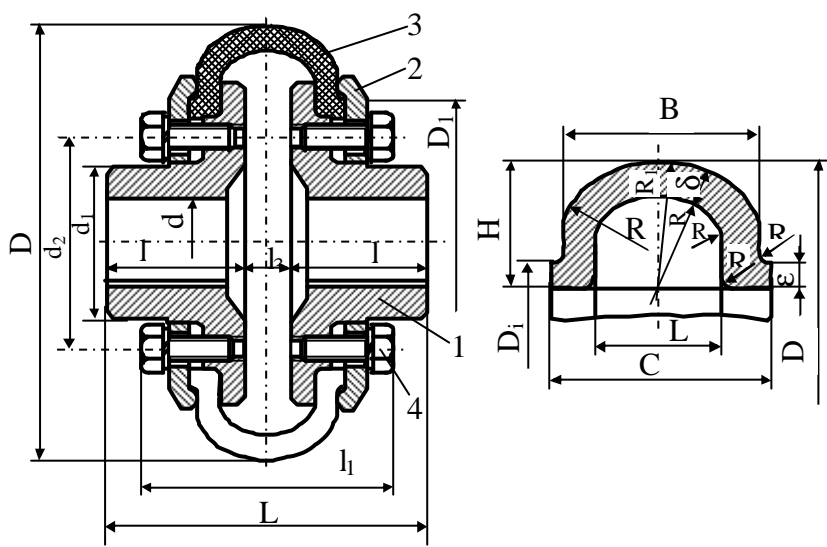

Figura 5.30

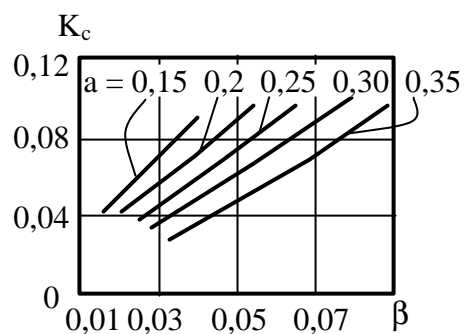

Figura 5.28

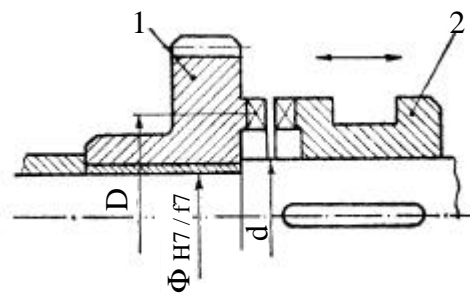

Figura 5.29

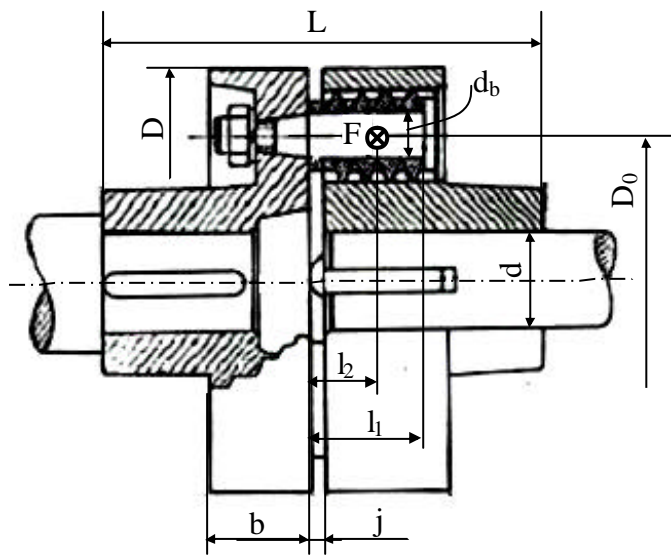

Figura 5.32

Arbore conductor

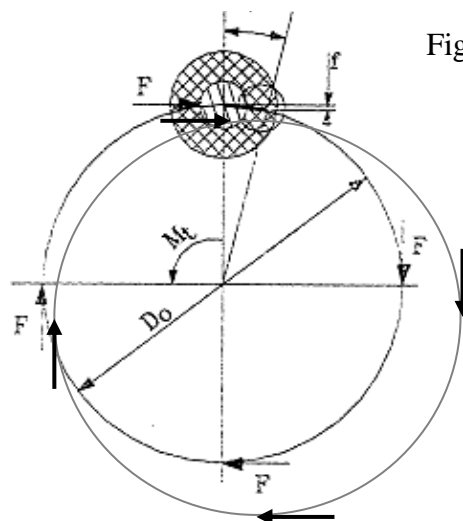

Figura 5.33

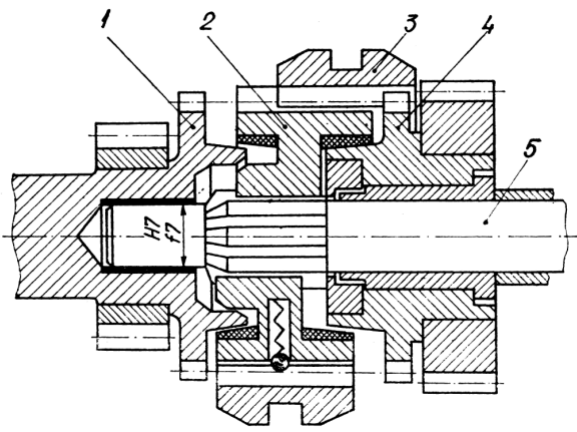

Figura 5.34

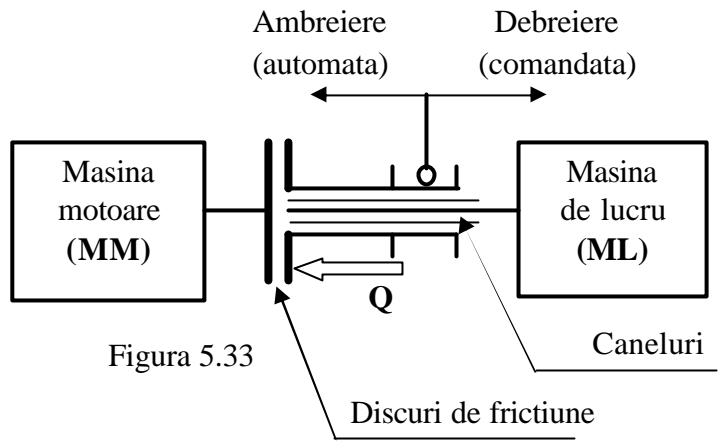

Figura 5.35

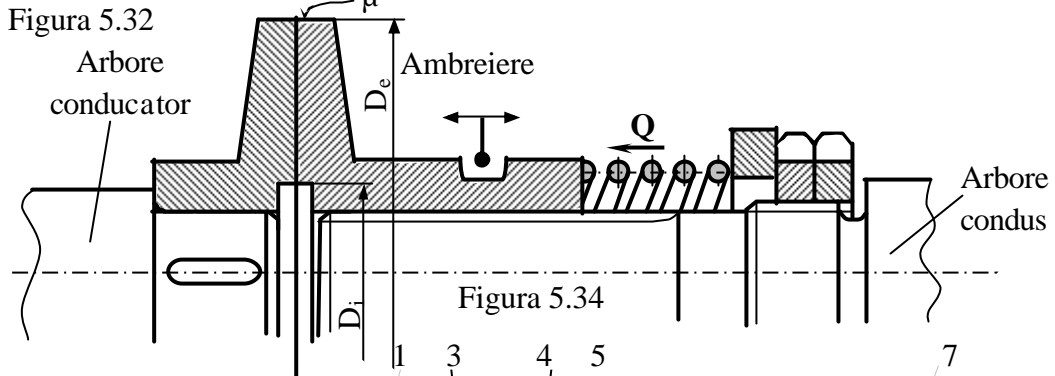

Figura 5.36

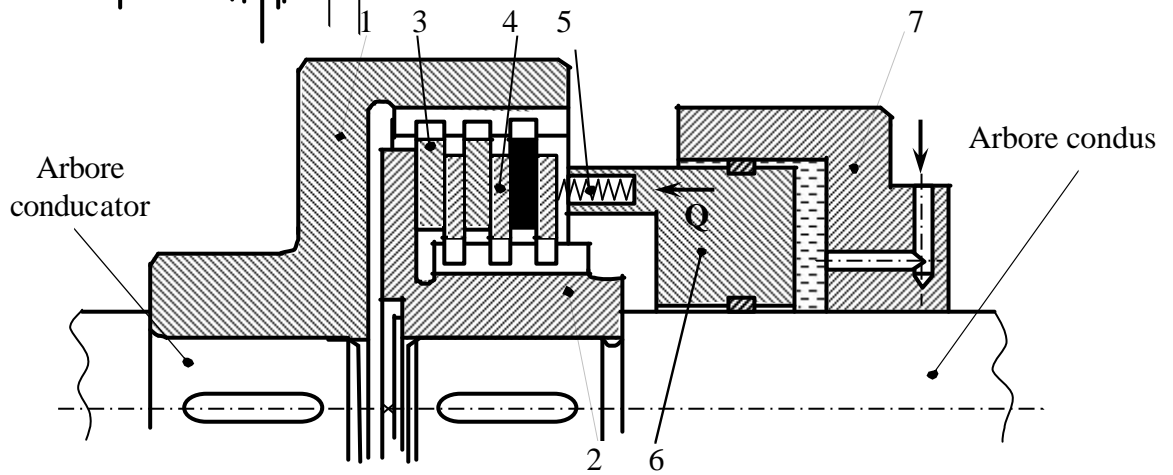

Figura 5.39

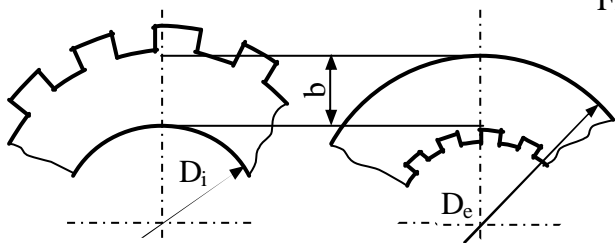

Figura 5.37

Figura 5.38

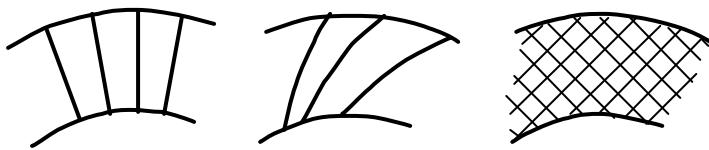

Figura 5.40

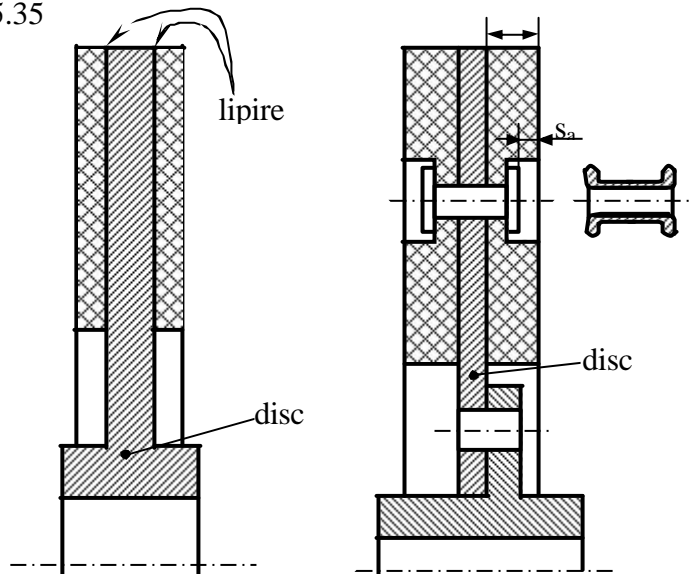

Figura 5.41

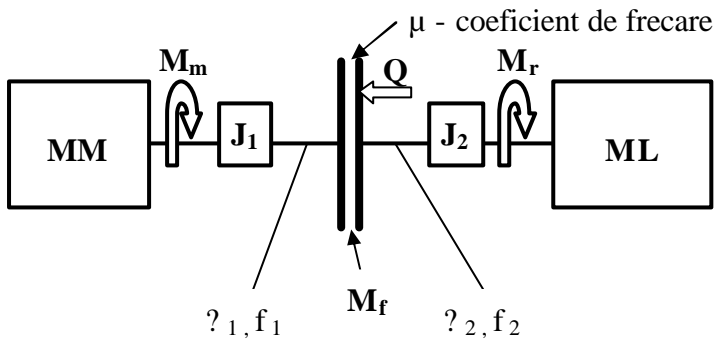

Figura 5.43

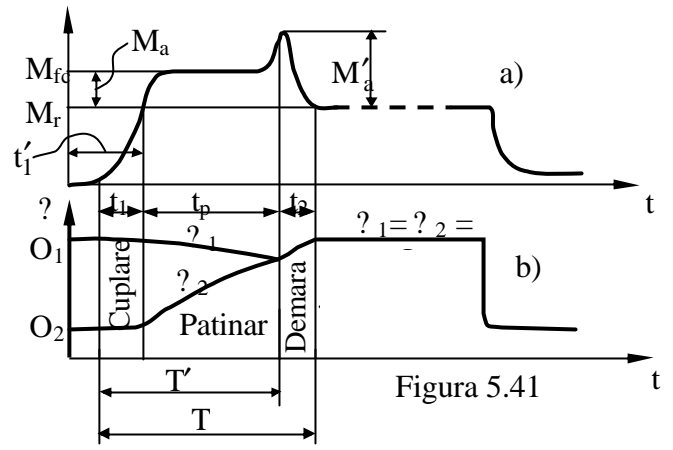

Figura 5.45

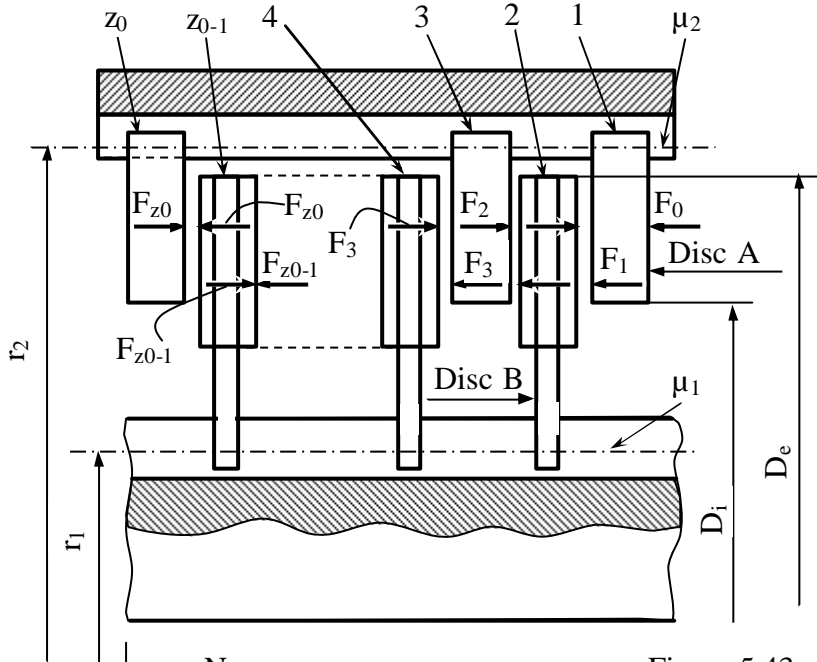

Figura 5.44

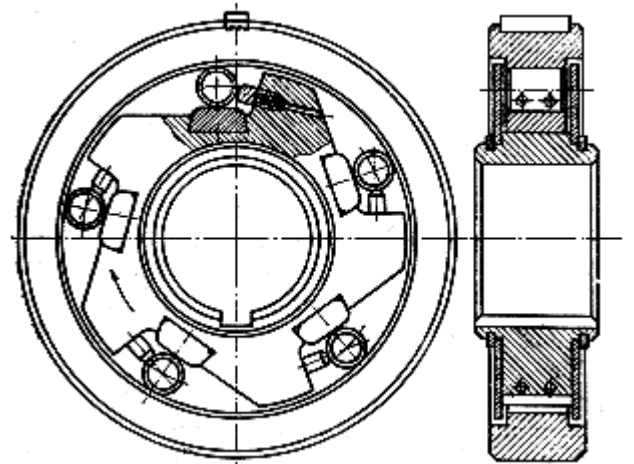

Figura 5.46

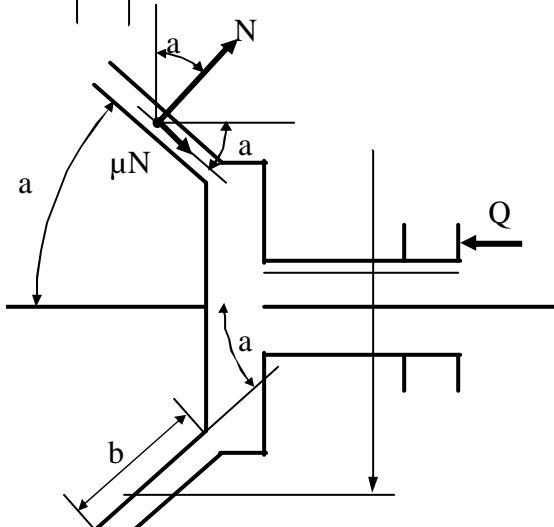

Figura 5.47

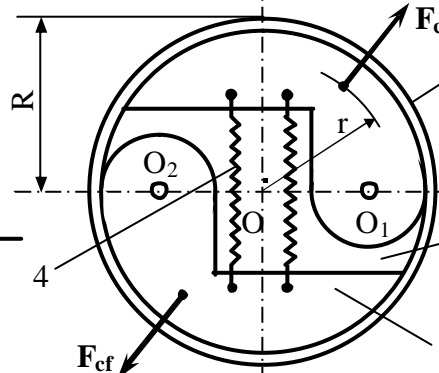

Figura 5.48

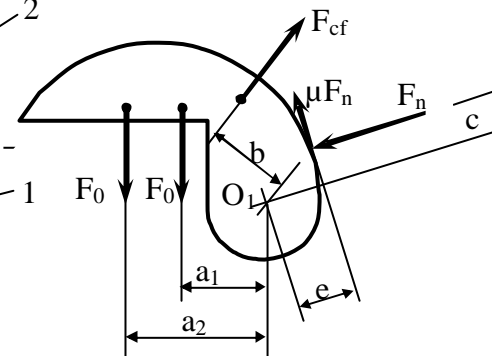

Figura 5.49

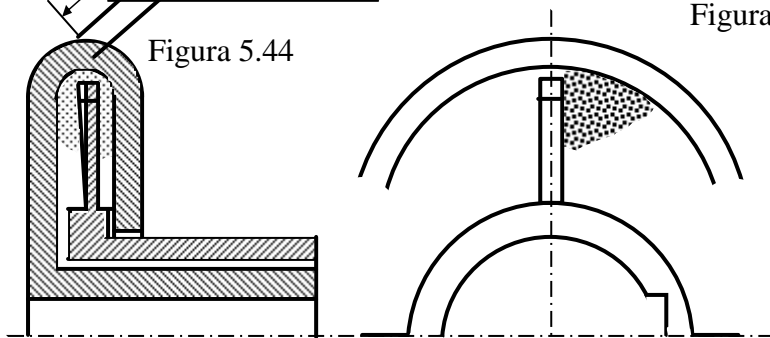

Decuplat

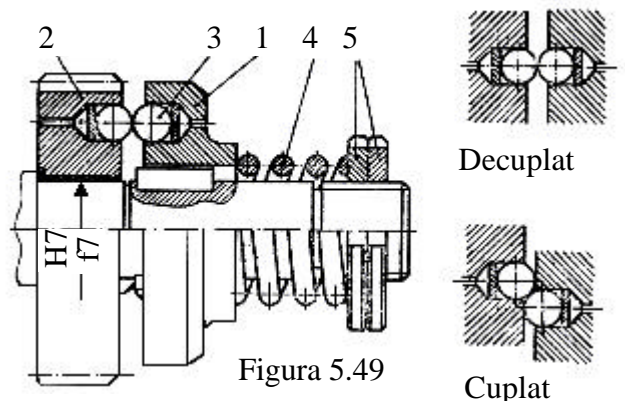
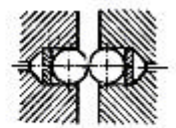
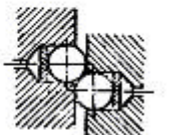

Cuplat